

INSTALLATION INSTRUCTIONS:

START BOTTOM RAIL APPROXIMATELY 3'(900mm) FROM BOTTOM OF LADDER OR BASE STARTING POSITION. LOCATE RAIL AT CENTER OF LADDER OR CLIMBWAY TO ALLOW BALANCED FOOT PLACEMENT.

ATTACH THE FIRST CLAMP 1'(300mm) FROM THE LOWER END OF THE BOTTOM RAIL SECTION. PLACE CLAMPS EVERY 4' TO 5' (1200 TO 1500mm) AS LADDER OR CLIMBWAY RUNGS PERMIT. LOCATE TOP CLAMP ON TOP RUNG AS ILLUSTRATED IN DRAWING. RAIL CAN SAFELY EXTEND 18\"/>

FOR HEIGHT ADJUSTMENT, CUT BOTTOM OF TOP RAIL ONLY.

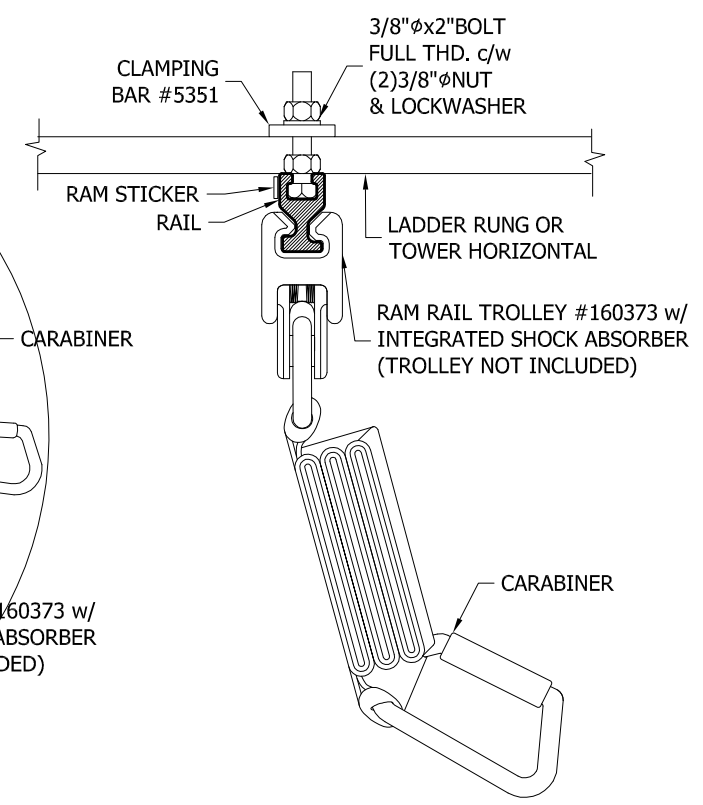

THE RAM RAIL SYSTEM IS CERTIFIED TO CSA Z259.2.4-15 AND MEETS OR EXCEEDS THE REQUIREMENTS OF ANSI Z359.1

REV.	DESCRIPTION	DWN.	CHK.	APP.
1	REVISED CSA STANDARD DATE: FEB.01.17		NZG	NRR
2	ADDED RAM LABEL DATE: AUG.11.22		MAO	NRR

DWG REFERENCE

PROJECT	COMMON PARTS and Hardware
CUSTOMER	Turris Corp.
SITE NAME	COMMON PARTS and Hardware

TITLE	SAFETY CLIMB RAM RAIL CL001		
DATE	DWG. BY:	PROJECT NO.	REV.
MAY.11.07	JGL	01-0011	2
ENGD. APPR:	CHKD BY:	DWG. NO.	
RSN	JCE	11CL0001-E01-01	